

Mini-change(7/8")公/母头, 面板式, 压接型, 前锁
Mini-change(7/8") Male/Female Panel mount, Crimp, Front fastened

RoHS

IP68







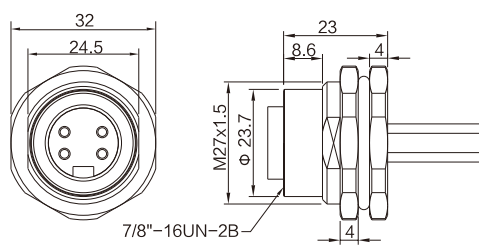
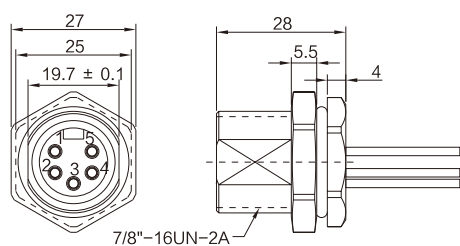

技术参数/Technical data

适用温度/Ambient temperature	-40°C ~ +90°C
胶芯材料/Connector insert	TPU
端子材料/Connector contacts	黄铜镀金/Brass with gold plated
螺丝/螺母材料/Contactor nut/screw	黄铜镀镍/Brass with nickel plated
密封材料/密封圈/Seal/O-ring	环氧树脂(Epoxy resin)/氟橡胶(FKM)
绝缘阻抗/Insulation resistance	≥100MΩ
接触阻抗/Contact resistance	≤5mΩ
是否屏蔽/Shielding or not	否/Unavailable
插拔次数/Mating endurance	>500次/Cycles
钻孔尺寸/Panel Cut-out	参照P276
防护等级/IP rating	IP68 (锁紧状态/in locked condition)

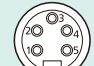

订货信息/Ordering information

芯数/Contacts		端子类型 Contacts termination	额定电流 Rated current	额定电压/Voltage		导体规格/Wire gauge		芯线绝缘 Wire insulation	公头型号/male model	母头型号/Female model
				交流(A/C)	直流(A/C)	AWG	mm²			
		压接型 Crimp version	13A	300V	300V	18	1.0	PVC/定制 Customized	78MAY03Z-Q	78FAY03Z-Q
		压接型 Crimp version	13A	300V	300V	18	1.0	PVC/定制 Customized	78MAY04Z-Q	78FAY04Z-Q
		压接型 Crimp version	8A	300V	300V	20	0.5	PVC/定制 Customized	78MAY05Z-Q	78FAY05Z-Q
		压接型 Crimp version	4A	250V	250V	24	0.25	PVC/定制 Customized	78MAY16Z-Q	

Mini-change(7/8")公头, 面板式, 压接型, 后锁
Mini-change(7/8") Male Panel mount, Crimp, Rear fastened

RoHS

IP68



技术参数/Technical data

适用温度/Ambient temperature	-40°C ~ +90°C
胶芯材料/Connector insert	TPU
端子材料/Connector contacts	黄铜镀金/Brass with gold plated
螺丝/螺母材料/Contactor nut/screw	黄铜镀镍/Brass with nickel plated
密封材料/密封圈/Seal/O-ring	环氧树脂(Epoxy resin)/氟橡胶(FKM)
绝缘阻抗/Insulation resistance	≥100MΩ
接触阻抗/Contact resistance	≤5mΩ
是否屏蔽/Shielding or not	否/Unavailable
钻孔尺寸/Panel Cut-out	参照P276
插拔次数/Mating endurance	>500次/Cycles
防护等级/IP rating	IP68 (锁紧状态/in locked condition)

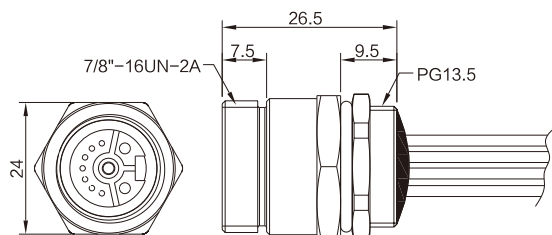
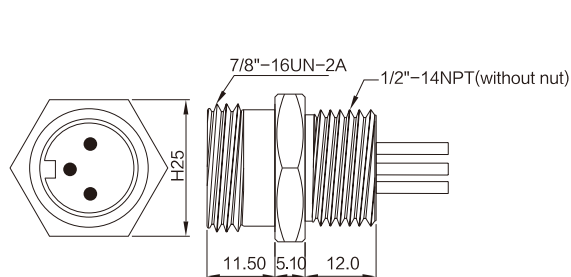

订货信息/Ordering information

芯数/Contacts	端子类型 Contacts termination	额定电流 Rated current	额定电压/Voltage		导体规格/Wire gauge		芯线绝缘 Wire insulation	公头型号/male model
			交流(A/C)	直流(A/C)	AWG	mm ²		
	压接型 Crimp version	13A	300V	300V	18	1.0	PVC/定制 Customized	78MAY03Z-H-A 78MAY03Z-H-B
	压接型 Crimp version	13A	300V	300V	18	1.0	PVC/定制 Customized	78MAY04Z-H-A 78MAY04Z-H-B
	压接型 Crimp version	8A	300V	300V	20	0.5	PVC/定制 Customized	78MAY05Z-H-A 78MAY05Z-H-B
	压接型 Crimp version	4A (信号 7Pins) 8A (电源 3Pins)	250V	250V	20~24	0.25~0.5	PVC/定制 Customized	78MAY10Z-H-A 78MAY10Z-H-B
	压接型 Crimp version	4A	250V	250V	24	0.25	PVC/定制 Customized	78MAY16Z-H-A 78MAY16Z-H-B

Mini-change(7/8")母头, 面板式, 压接型, 后锁
Mini-change(7/8") Female Panel mount, Crimp, Rear fastened

RoHS

IP68



技术参数/Technical data

适用温度/Ambient temperature	-40°C ~ +90°C
胶芯材料/Connector insert	TPU
端子材料/Connector contacts	黄铜镀金/Brass with gold plated
螺丝/螺母材料/Contact nut/screw	黄铜镀镍/Brass with nickel plated
密封材料/密封圈/Seal/O-ring	环氧树脂(Epoxy resin)/氟橡胶(FKM)
绝缘阻抗/Insulation resistance	≥100MΩ
接触阻抗/Contact resistance	≤5mΩ
是否屏蔽/Shielding or not	否/Unavailable
钻孔尺寸/Panel Cut-out	参照P276
插拔次数/Mating endurance	>500次/Cycles
防护等级/IP rating	IP68 (锁紧状态/in locked condition)

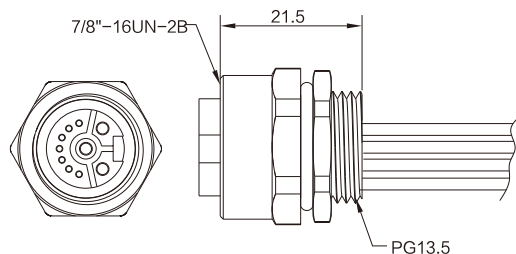
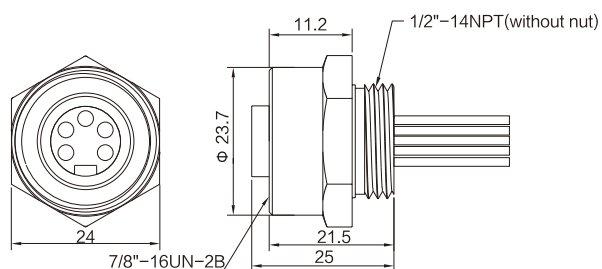

订货信息/Ordering information

芯数/Contacts	端子类型 Contacts termination	额定电流 Rated current	额定电压/Voltage		导体规格/Wire gauge		芯线绝缘 Wire insulation	母头型号/Female model
			交流(A/C)	直流(A/C)	AWG	mm ²		
	压接型 Crimp version	13A	300V	300V	18	1.0	PVC/定制 Customized	78FAY03Z-H-A 78FAY03Z-H-B
	压接型 Crimp version	13A	300V	300V	18	1.0	PVC/定制 Customized	78FAY04Z-H-A 78FAY04Z-H-B
	压接型 Crimp version	8A	300V	300V	20	0.5	PVC/定制 Customized	78FAY05Z-H-A 78FAY05Z-H-B
	压接型 Crimp version	4A (信号 7Pins) 8A (电源 3Pins)	250V	250V	20~24	0.25~0.5	PVC/定制 Customized	78FAY10Z-H-A 78FAY10Z-H-B

Mini-change(7/8")公/母头, 面板式, PCB型, 后锁
Mini-change(7/8") Male/Female Panel mount, PCB type, Rear fastened

RoHS

IP68

技术参数/Technical data

适用温度/Ambient temperature	-40°C ~ +90°C
胶芯材料/Connector insert	TPU
端子材料/Connector contacts	黄铜镀金/Brass with gold plated
螺丝/螺母材料/Contactor nut/screw	黄铜镀镍/Brass with nickel plated
密封材料/密封圈/Seal/O-ring	环氧树脂(Epoxy resin)/氟橡胶(FKM)
绝缘阻抗/Insulation resistance	≥100MΩ
接触阻抗/Contact resistance	≤5mΩ
是否屏蔽/Shielding or not	否/Unavailable
钻孔尺寸/Panel Cut-out	参照P276
插拔次数/Mating endurance	>500次/Cycles
防护等级/IP rating	IP68 (锁紧状态/in locked condition)

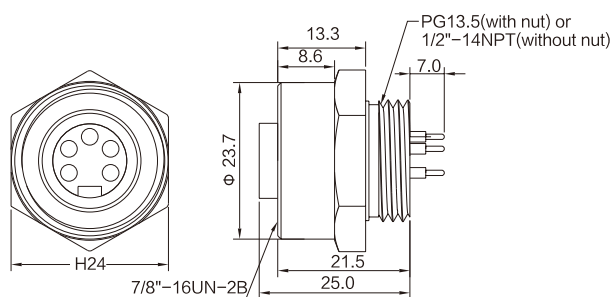
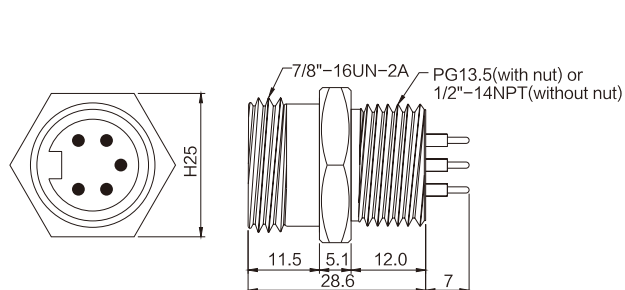

订货信息/Ordering information

芯数/Contacts	端子类型 Contacts termination	额定电流 Rated current	额定电压/Voltage		公头型号/male model	母头型号/Female model
			交流(A/C)	直流(A/C)		
	PCB型 PCB version	13A	300V	300V	78MA03Z-H-A 78MA03Z-H-B	78FA03Z-H-A 78FA03Z-H-B
	PCB型 PCB version	13A	300V	300V	78MA04Z-H-A 78MA04Z-H-B	78FA04Z-H-A 78FA04Z-H-B
	PCB型 PCB version	8A	300V	300V	78MA05Z-H-A 78MA05Z-H-B	78FA05Z-H-A 78FA05Z-H-B
	PCB型 PCB version	4A	250V	250V	78MA16Z-H-A 78MA16Z-H-B	78FA16Z-H-A 78FA16Z-H-B

Mini-change(7/8") PCB孔位分布图 & 钻孔尺寸

■ PCB 孔位分布图

7/8" 公头连接器

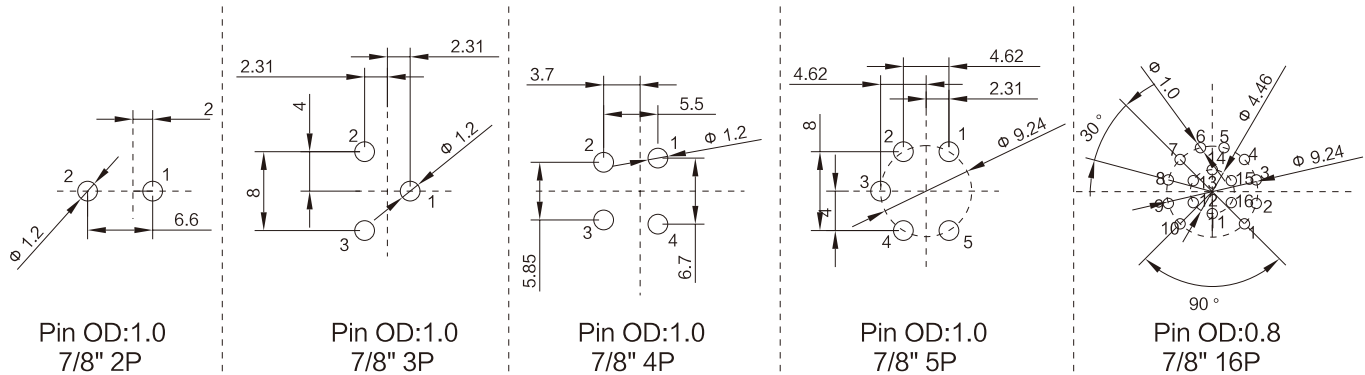

建议PCB孔位分布图

7/8" 母头连接器

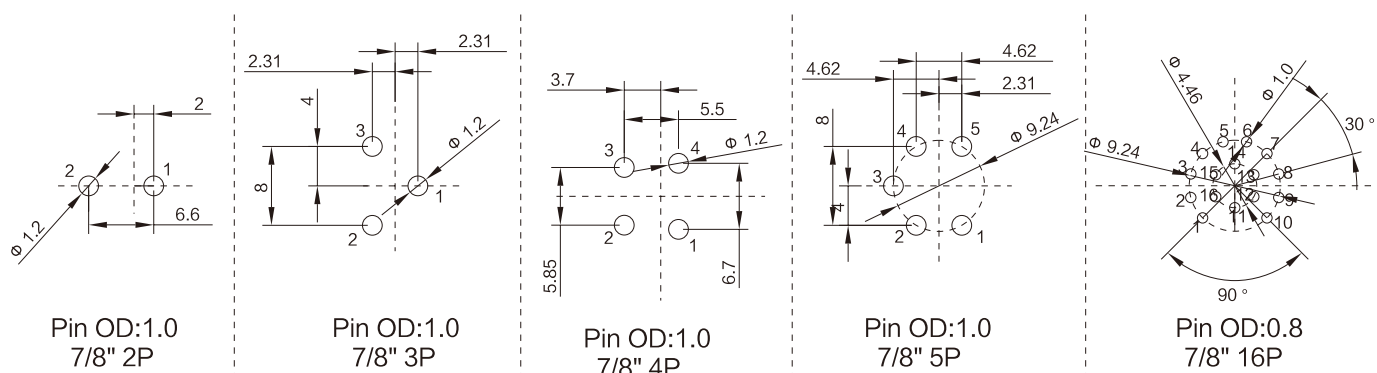

建议PCB孔位分布图

■ 钻孔尺寸

