

**M23电源类, 面板式, 直头, 前锁, 压接型, 公螺纹**  
**M23 Power, Panel Mount, Crimp, Male Thread**

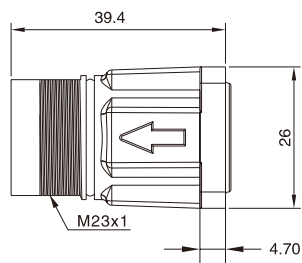

技术参数/Technical data

胶芯材料/Connector insert	PA
端子材料/Connector contacts	黄铜镀金/Brass with gold plated
主体材料/Connector body	锌合金镀镍/Zinc alloy with nickel plated
螺丝/螺母材料/Contactor nut/screw	锌合金镀镍/Zinc alloy with nickel plated
密封材料/密封圈/Seal/O-ring	FKM/NBR
绝缘阻抗/Insulation resistance	≥100MΩ
接触阻抗/Contact resistance	≤5mΩ
适用温度/Ambient temperature	-40°C ~ +125°C
插拔次数/Mating endurance	>800次/Cycles
防护等级/IP rating	IP68 (锁紧状态/in locked condition)
线径范围/Cable OD range	2.0~13mm
组装指南/Assembly instruction	P324~P330

电气参数/Electrical data & Mechanical data

Pin位组合	6(5+PE)		8(4+3+PE)	
	5+PE	4	3	PE
芯数	5+PE	4	3	PE
端子直径(mm)	2.0(0.25~4.0mm)	1.0(0.08~1.0mm)	2.0(0.25~4.0mm)	
额定电流@ 20°C(A)	30	9	30	
额定电压(V)	630	250	630	
额定脉冲电压(V)	6000	4000	6000	
过电保护等级	II			
污染等级	III			

订货信息/Ordering information

芯数/Contacts	端子外径/Contact OD	公针/Pin	型号/Model
06 (5+PE)	2		P-M23STSMY06C-Q-A

芯数/Contacts	端子外径/Contact OD	公针/Pin	型号/Model
08 (4+3+PE)	3+PE	2	
	4	1	

**M23电源类, 面板式, 直头, 前锁, 压接型, 母螺纹**  
**M23 Power, Panel Mount, Crimp, Female Thread**

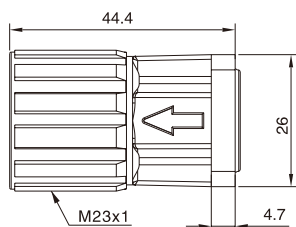

技术参数/Technical data

胶芯材料/Connector insert	PA
端子材料/Connector contacts	黄铜镀金/Brass with gold plated
主体材料/Connector body	锌合金镀镍/Zinc alloy with nickel plated
螺丝/螺母材料/Contact nut/screw	锌合金镀镍/Zinc alloy with nickel plated
密封材料/密封圈/Seal/O-ring	FKM/NBR
绝缘阻抗/Insulation resistance	≥100MΩ
接触阻抗/Contact resistance	≤5mΩ
适用温度/Ambient temperature	-40°C ~ +125°C
插拔次数/Mating endurance	>800次/Cycles
防护等级/IP rating	IP68 (锁紧状态/in locked condition)
线径范围/Cable OD range	2.0~13mm
组装指南/Assembly instruction	P324~P330

电气参数/Electrical data & Mechanical data

Pin位组合	6(5+PE)		8(4+3+PE)	
	5+PE	4	3	PE
芯数	5+PE	4	3	PE
端子直径(mm)	2.0(0.25~4.0mm)	1.0(0.08~1.0mm)	2.0(0.25~4.0mm)	
额定电流@ 20°C(A)	30	9	30	
额定电压(V)	630	250	630	
额定脉冲电压(V)	6000	4000	6000	
过电保护等级		II		
污染等级		III		

订货信息/Ordering information

芯数/Contacts	端子外径/Contact OD	公针/Pin	型号/Model
06 (5+PE)	2		P-M23STNfy06C-Q-A

芯数/Contacts	端子外径/Contact OD	公针/Pin	型号/Model
08 (4+3+PE)	3+PE	2	
	4	1	

**M23电源类, 面板式, 弯头, 前锁, 压接型, 公螺纹**  
**M23 Power, Panel Mount, Crimp, Male Thread**



技术参数/Technical data

胶芯材料/Connector insert	PA
端子材料/Connector contacts	黄铜镀金/Brass with gold plated
主体材料/Connector body	锌合金镀镍/Zinc alloy with nickel plated
螺丝/螺母材料/Contact nut/screw	锌合金镀镍/Zinc alloy with nickel plated
密封材料/密封圈/Seal/O-ring	FKM/NBR
绝缘阻抗/Insulation resistance	≥100MΩ
接触阻抗/Contact resistance	≤5mΩ
适用温度/Ambient temperature	-40°C ~ +125°C
插拔次数/Mating endurance	>800次/Cycles
防护等级/IP rating	IP68 (锁紧状态/in locked condition)
线径范围/Cable OD range	2.0~13mm
组装指南/Assembly instruction	参照P324~P330

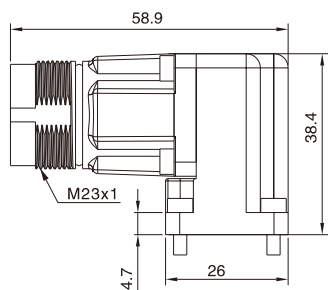

电气参数/Electrical data & Mechanical data

Pin位组合	6(5+PE)		8(4+3+PE)	
芯数	5+PE	4	3	PE
端子直径(mm)	2.0(0.25~4.0mm)		2.0(0.25~4.0mm)	
额定电流@ 20°C(A)	30	9	30	
额定电压(V)	630	250	630	
额定脉冲电压(V)	6000	4000	6000	
过电保护等级	II			
污染等级	III			

订货信息/Ordering information

芯数/Contacts	端子外径/Contact OD	公针/Pin	型号/Model
06 (5+PE)	2		P-M23RASY06C-Q-A

芯数/Contacts	端子外径/Contact OD	公针/Pin	型号/Model
08 (4+3+PE)	3+PE	2	
	4	1	

**M23电源类, 面板式, 弯头, 前锁, 压接型, 母螺纹**  
**M23 Power, Panel Mount, Crimp, Female Thread**



技术参数/Technical data

胶芯材料/Connector insert	PA
端子材料/Connector contacts	黄铜镀金/Brass with gold plated
主体材料/Connector body	锌合金镀镍/Zinc alloy with nickel plated
螺丝/螺母材料/Contact nut/screw	锌合金镀镍/Zinc alloy with nickel plated
密封材料/密封圈/Seal/O-ring	FKM/NBR
绝缘阻抗/Insulation resistance	≥100MΩ
接触阻抗/Contact resistance	≤5mΩ
适用温度/Ambient temperature	-40°C ~ +125°C
插拔次数/Mating endurance	>800次/Cycles
防护等级/IP rating	IP68 (锁紧状态/in locked condition)
线径范围/Cable OD range	2.0~13mm
组装指南/Assembly instruction	参照P324~P330

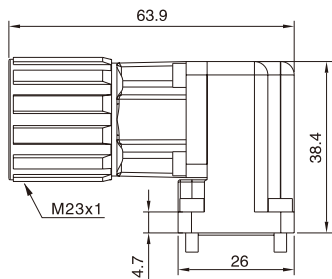

电气参数/Electrical data & Mechanical data

Pin位组合	6(5+PE)		8(4+3+PE)	
芯数	5+PE	4	3	PE
端子直径(mm)	2.0(0.25~4.0mm)		2.0(0.25~4.0mm)	
额定电流@ 20°C(A)	30	9	30	
额定电压(V)	630	250	630	
额定脉冲电压(V)	6000	4000	6000	
过电保护等级	II			
污染等级	III			

订货信息/Ordering information

芯数/Contacts	端子外径/Contact OD	公针/Pin	型号/Model
06 (5+PE)	2		P-M23RANFY06C-Q-A

芯数/Contacts	端子外径/Contact OD	公针/Pin	型号/Model
08 (4+3+PE)	3+PE	2	
	4	1	