

M12 公头, 面板式, 压接型, 前锁, T-coding
M12 Male Panel mount, Crimp, Front fastened, T-coding

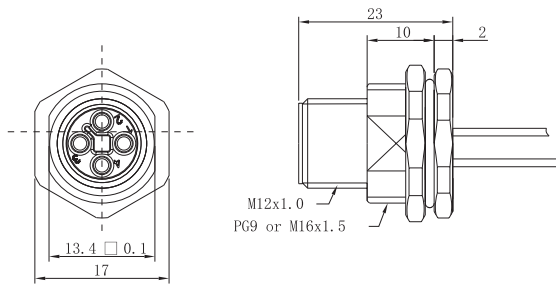

技术参数/Technical data

适用温度/Ambient temperature	-20°C ~ +80°C
胶芯材料/Connector insert	PA
端子材料/Connector contacts	黄铜镀金/Brass with gold plated
螺丝/螺母材料/Connector nut/screw	黄铜镀镍/Brass with nickel plated
密封材料/密封圈/Seal/O-ring	环氧树脂(Epoxy resin)/氟橡胶(FKM)
绝缘阻抗/Insulation resistance	≥100MΩ
接触阻抗/Contact resistance	≤5mΩ
是否屏蔽/Shielding or not	否/Unavailable
插拔次数/Mating endurance	>500次/Cycles
防护等级/IP rating	IP68 (锁紧状态/in locked condition)
钻孔尺寸/Panel cut-out	参照P225



订货信息/Ordering information

芯数/Contacts	端子类型 Contacts termination	额定电流 Rated current	额定电压 Voltage	导体规格/Wire gauge		线材外被 Cable jacket	公头型号/Male model
				AWG	mm ²		
	压接型 Crimp version	12A(40°C)	60V	16	1.5	PVC/定制	M12MATY04C-Q7

M12 母头, 面板式, 压接型, 前锁, T-coding
M12 Female Panel mount, Crimp, Front fastened, T-coding



技术参数/Technical data

适用温度/Ambient temperature	-20°C ~ +80°C
胶芯材料/Connector insert	PA
端子材料/Connector contacts	黄铜镀金/Brass with gold plated
螺丝/螺母材料/Connector nut/screw	黄铜镀镍/Brass with nickel plated
密封材料/密封圈/Seal/O-ring	环氧树脂(Epoxy resin)/氟橡胶(FKM)
绝缘阻抗/Insulation resistance	≥100MΩ
接触阻抗/Contact resistance	≤5mΩ
是否屏蔽/Shielding or not	否/Unavailable
插拔次数/Mating endurance	>500次/Cycles
防护等级/IP rating	IP68 (锁紧状态/in locked condition)
钻孔尺寸/Panel cut-out	参照P225

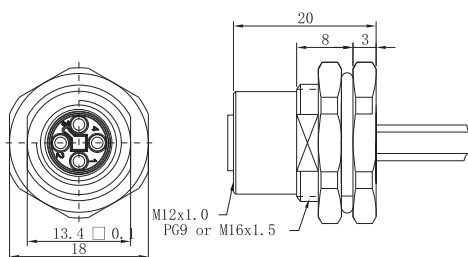

订货信息/Ordering information

芯数/Contacts	端子类型 Contacts termination	额定电流 Rated current	额定电压 Voltage	导体规格/Wire gauge		线材外被 Cable jacket	母头型号/Female model
				AWG	mm ²		
	压接型 Crimp version	12A(40°C)	60V	16	1.5	PVC/定制	M12FATY04C-Q7